

OPTONICA

SKU: 15301

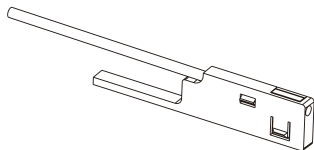

MANUALE DELL'USO

Installare

1



Spegnere
l'alimentazione

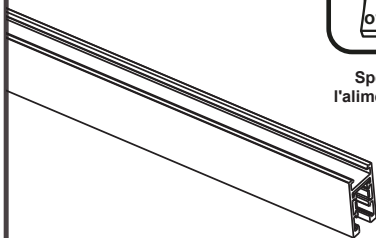

2

Si prega di verificare che il
modulo si adatti
perfettamente al binario e
che non vi siano sporgenze

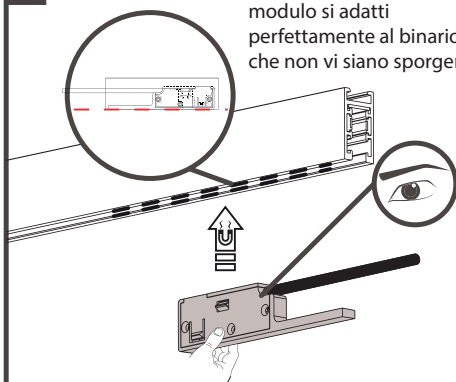

Disinstallare

1

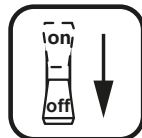

Spegnere
l'alimentazione

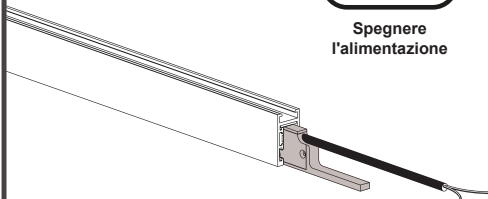

2

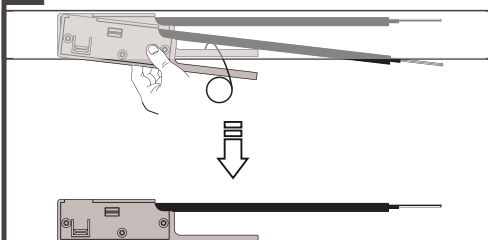

Utilizzare il gancio per agganciare l'estremità del
modulo ed estrarlo con le mani

OPTONICA

MANUALE DELL'USO

SKU: 15302

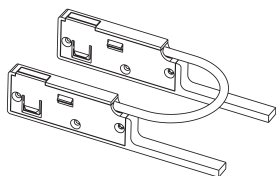

Install

1



Spegnere
l'alimentazione

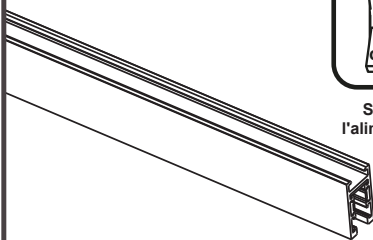

2

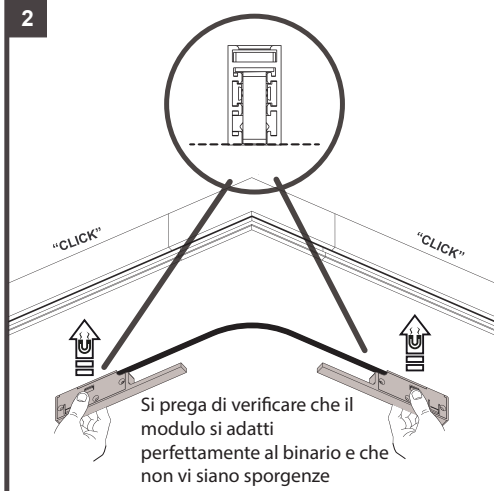

3

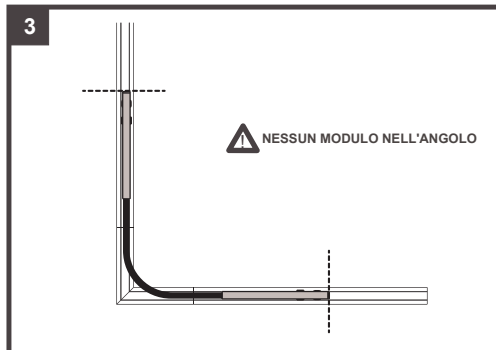

Uninstall

1

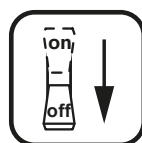

Spegnere
l'alimentazione

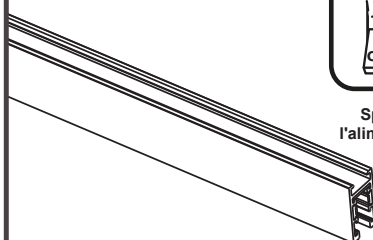

2

